

FOR SALE
\$999,990

Land For Sale
Development Opportunity



2038 Dallas Stanley Hwy | Stanley, NC 28164

Property Information

22.61 acre parcel Zoning R-2 Moderate Parcel ID 220390

Road Frontage:

Approx 950' of frontage on Dallas Stanley Hwy
Traffic: 10,500 vehicles daily
Approx 800' on McKeun Rd
Traffic: 1600 vehicles daily

2 Buildings: 1 - 40'x50' 1 - 20'x20'

Distance to:

Stanley: 2 miles Dallas: 4 miles
Gastonia: 8 Miles Charlotte: 20 miles
Charlotte Douglas International Airport: 16 Miles



For More Information: 980-522-8363



Mountain View
Commercial Real Estate

100 W. Main Street #307, Gastonia, NC 28052

Mo Sallah
Mo@mvcommercialre.com
Patty Neinst
Patty@mvcommercialre.com

FOR SALE

\$999,990

Land For Sale

**2038 Dallas Stanley Hwy
Stanley, NC 28164**

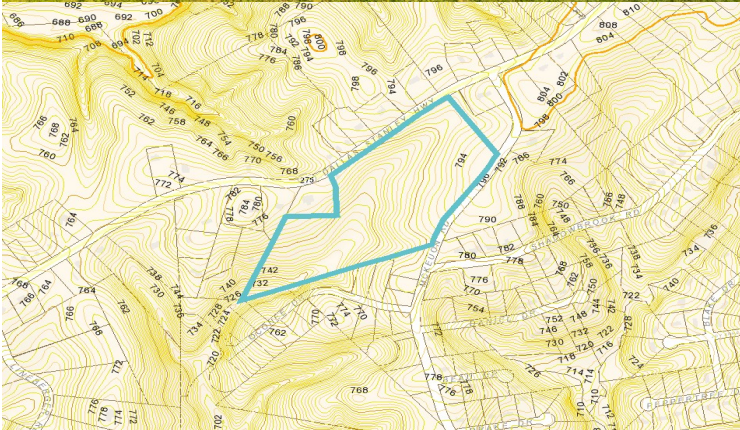

980-522-8363

Mo Sallah

Mo@mvcommercialre.com

Patty Neinst

Patty@mvcommercialre.com

Mountain View
Commercial Real Estate

FOR SALE

\$999,990

Land For Sale

**2038 Dallas Stanley Hwy
Stanley, NC 28164**



980-522-8363

Mo Sallah

Mo@mvcommercialre.com

Patty Neinast

Patty@mvcommercialre.com

Mountain View
Commercial Real Estate